

Krananschlagpuffer Typ GP-QP - mit quadratischer Grundplatte

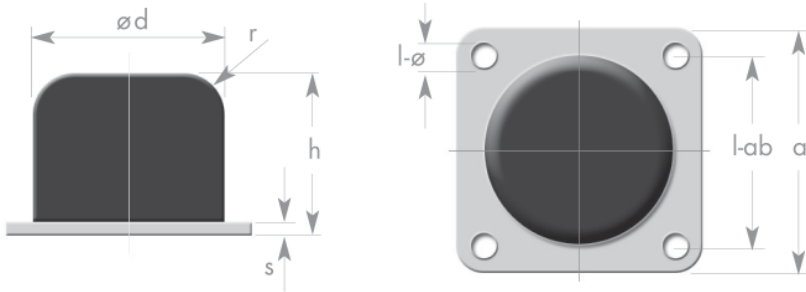

Material: Standard in NK/SBR 70° +/- 5 Shore
andere Qualitäten auf Anfrage

Metallteile: ST37, weiß verzinkt, CRVI - frei

| Art. Nr. | $\varnothing d$ | h | a | l-ab | l- \varnothing | r | s |
|----------|-----------------|-----|-----|------|------------------|------|---|
| 40x32 | 40 | 32 | 50 | 40 | 5,5 | 8 | 2 |
| 50x40 | 50 | 40 | 63 | 50 | 6,5 | 10 | 3 |
| 63x50 | 63 | 50 | 80 | 63 | 6,5 | 12,5 | 4 |
| 80x63 | 80 | 63 | 100 | 80 | 9 | 18 | 5 |
| 100x80 | 100 | 80 | 125 | 100 | 9 | 20 | 6 |
| 125x100 | 125 | 100 | 160 | 125 | 11 | 25 | 6 |
| 160x125 | 160 | 125 | 200 | 160 | 11 | 32 | 8 |
| 200x160 | 200 | 160 | 250 | 200 | 13 | 40 | 8 |

Krananschlagpuffer Typ GP-1I - mit Innengewinde

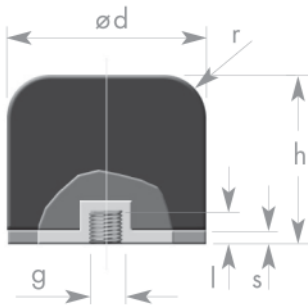

Material: Standard in NK/SBR 70° +/- 5 Shore
andere Qualitäten auf Anfrage

Metallteile: ST37, weiß verzinkt, CRVI - frei

| Art. Nr. | $\varnothing d$ | h | g | r | s | l |
|----------|-----------------|-----|-----|------|---|----|
| 40x32 | 40 | 32 | M8 | 8 | 2 | 8 |
| 50x40 | 50 | 40 | M10 | 10 | 2 | 10 |
| 63x50 | 63 | 50 | M10 | 12,5 | 3 | 10 |
| 80x63 | 80 | 63 | M12 | 18 | 3 | 12 |
| 100x80 | 100 | 80 | M12 | 20 | 3 | 12 |
| 125x100 | 125 | 100 | M16 | 25 | 4 | 16 |
| 160x125 | 160 | 125 | M16 | 32 | 6 | 16 |
| 200x160 | 200 | 160 | M20 | 40 | 6 | 20 |